

GENERAL NOTE:

INSTALL A TOE BOARD PER MDCIS GENERAL INDUSTRY SAFETY STANDARD, PART 2. WHERE PEOPLE PASS UNDERNEATH, THERE IS MOVING EQUIPMENT, OR THERE ARE EQUIPMENT OR TOOLS THAT COULD FALL.

GALVANIZED TUBE RAILING
(TYPICAL)

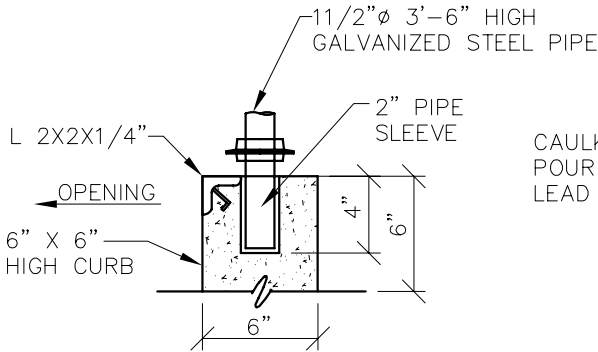

CAULK OR POUR WITH LEAD

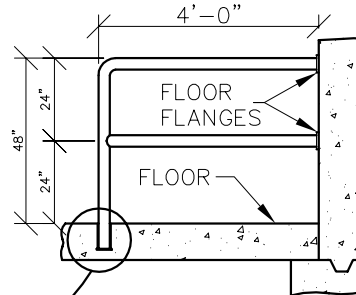

3/4" X 1/4" ϕ PLATE WELDED TO 2 1/2" ϕ GALVANIZED STEEL PIPE SLEEVE

REMOVABLE
HAND RAIL

ELEVATION

(PIPE RAILING AND COMPONENTS SHALL BE GALVANIZED)

C					
B					
A					
	DESCRIPTION	DRW	CKD	APP	DATE
REVISIONS					
DRAWN BY: S.D.A.					
CHECKED BY: S.D.A.					
APPROVED:					

RAILING

SCALE: NONE

CITY OF DETROIT
WATER AND SEWERAGE
DEPARTMENT
ENGINEERING
DIVISION

SHEET 1 OF 1

DWG No. 05520-01